



Pissouri Laniti Villa

Ref: 1968



Price: € 245,000
Type: Link Villa
Area: Countryside

Location: Limassol > Pissouri **Bedrooms:** 3
Covered Area: 167 m2 **Bathrooms:** 3
Uncovered Area: 9 m2 **Ref:** 1968
Plot Size: 330 m2





Immaculate end terrace with villa sized proportions at the top of Pissouri. Within easy walking distance to high end dining establishments, atmospheric bars and Cypriot coffee shops in the popular village square the location is highly sought after for its proximity to village amenities. Add a private pool with a mature garden setting and a cool breeze; you have the recipe for a fantastic lifestyle home, ideal as a spacious holiday retreat or a permanent Cyprus residence in a great location.

Entry is via a handsome door which opens in a hallway leading on to large open plan living space.

Here is a real sense of space and light, the colour palette creating a cool atmosphere for those hotter than hot days. This villa provides comfort for all seasons with full air conditioning and cosy open fireplace for those cooler evenings.

Your mature garden and pristine pool are on full view via two large patio doors leading out to your Summer terrace.

To the right, via a light and bright spacious dining area you enter a separate, newly fitted, modern kitchen with all modern conveniences.

Leading through the large patio doors you find yourself admiring the garden from you shaded dining space where al fresco dining and relaxed living have been fully catered for on those sunny days.

The ground floor is completed with a Guest WC.

Upstairs off of a pretty, bright hallway there are three double bedrooms with quality wooden floors. The Master Bedroom benefits from an en-suite with quality tiles and fittings. There is also a large balcony from which to admire the village on a balmy evening. The large family bathroom has an immaculate white suite.

This beautifully maintained home with its exceptional building quality is a must see for the size, the lifestyle conveniences and the fantastic village location.

- ✓ Title Deeds
- ✓ Residential-Holiday
- ✓ Westerly Aspect
- ✓ Entry portico
- ✓ Open balconies
- ✓ Open terraces
- ✓ Covered Terrace
- ✓ Undercover parking
- ✓ Limassol Centre - 30km
- ✓ Swimming Pool
- ✓ Private garden
- ✓ Mature garden
- ✓ Views to Hills
- ✓ High Spec Interior
- ✓ Open plan living area
- ✓ Living rooms terrace
- ✓ Fireplace
- ✓ Separate kitchen
- ✓ Fully equipped kitchen
- ✓ Double bedrooms
- ✓ Master with en-suite
- ✓ Master - balcony
- ✓ Built-in wardrobes
- ✓ Full bathroom
- ✓ Guest WC
- ✓ Pressurised water system
- ✓ Fully Furnished
- ✓ Air condition
- ✓ Double glazing
- ✓ Fly screens
- ✓ Quality blinds
- ✓ WI FI
- ✓ Sea - 2km
- ✓ Restaurants - 200m
- ✓ Golf - 12km
- ✓ Village Centre - 500m
- ✓ Airport - 23km
- ✓ Build - 2005

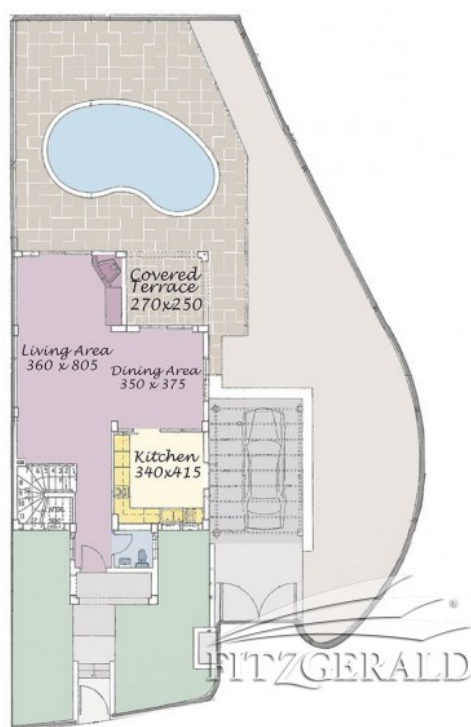
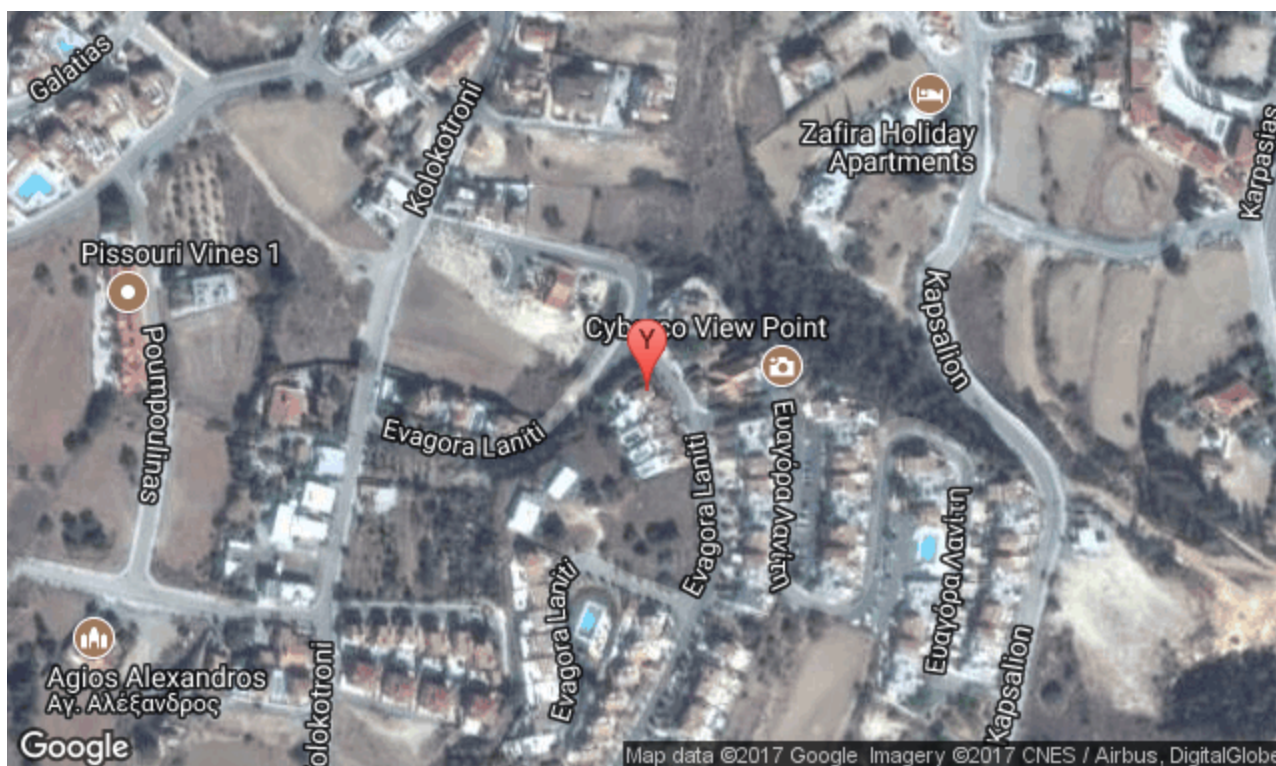

We endeavour to make our sales particulars accurate and reliable, however, they do not constitute or form part of an offer or any contract and none is to be relied upon as statements of representation of fact. Any systems, services and appliances are not tested by us and no guaranteed as to their operating ability is given. All photographs, measurements, floor plans and distances referred to are given as a guide to prospective buyers only. Copyright of all details, photographs and floor plans remain exclusive to Mandziak Estates.